

WoodLocker

New turnable stanchion system for transporting round, sawn wood and containers



- ◆ Patented turnable stanchion system by **INNOFREIGHT** with a novel stanchion lock, stanchion unit tested for load capacity of 70kNm
- ◆ Easy and quick tilting of the stanchions, operating carried out from the ground
- ◆ Tension spring facilitates stanchion movement at folding

System construction:

- ◆ Hot-dip galvanized, weight: 290kg, Stanchion distance: 2,000mm
- ◆ Loading width: 2,650mm, stanchion height: 2,000mm



Functioning:

Spring facilitates the operation

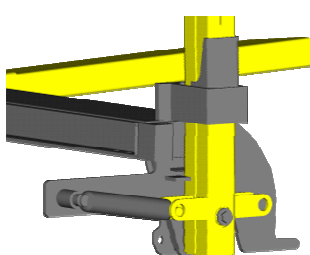

Lift the stanchion shoe

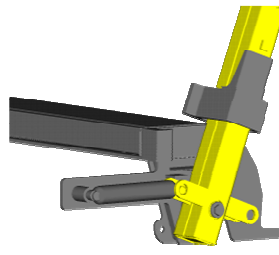

Turn the stanchion

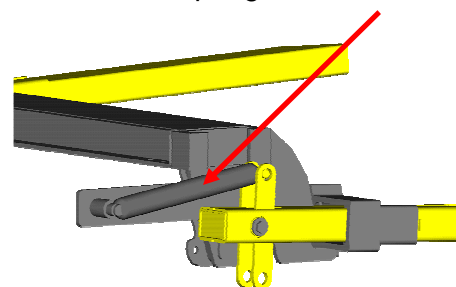

Fold the stanchion

Example of loading a 2-axle-wagon:

Stanchions folded:



Container loading (e.g. wood chips)

Stanchions unfolded:



Loading of round and sawn wood



One type of wagon for various goods!

Advantages for customers:

- ◆ Uniform, standardised wagon material
- ◆ Easy operation of the stanchions
- ◆ High loading volume and high carrying capacity
- ◆ Optimised logistics through reduction of empty runs
- ◆ Stanchion systems are installed on the wagon, easy maintenance
- ◆ ÖBB and DB trust this new technology

Interested?

Contact: INNOFREIGHT Rail GmbH, Grazer Straße 18, A-8600 Bruck/Mur, Austria.
 Tel.: 03862/8989-242, Fax: -241. [mailto: office@innofreight.com](mailto:office@innofreight.com), www.innofreight.com